



## Posi-Temp Cartridge Cleaning Instructions

Why would a 1222 cartridge have to be cleaned?

As with other mechanical devices with moving part(s), the Posi-Temp cartridge may occasionally require minor cleaning maintenance. This is especially true during the installation process when debris might pass into the cartridge, in situations where there is water with a high mineral/sediment content or when showers are used infrequently (such as in a vacation home or guest bathroom).

When does a 1222 cartridge need to be cleaned?

Inside the 1222 cartridge there is a moving part that equalizes the hot and cold water flow called the "balancing spool".



If the balancing spool gets stuck, the cartridge can not regulate the hot and cold water and the shower will not function properly.

Troubleshooting Tips (before removing the cartridge):

- § Check that both the hot AND cold supply lines are turned "ON" together
- § Remember that the "on" handle/knob should be rotated to turn on and NOT pulled
  
- § Many PosiTemp valves feature ¼ turn stops on the water inlets. These stops are rotated using a screwdriver and turned to the vertical position for "OFF" and the horizontal for "ON"

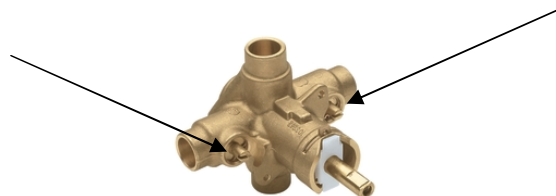

## Instructions for Cleaning:

Step 1: Turn off the water supply lines to the shower unit (the location will vary depending upon the plumbing configuration and may require that the water for the entire residence be shut off)

Step 2: Remove the handle and the retainer clip. If the clip is not visible, remove the escutcheon screws and escutcheon

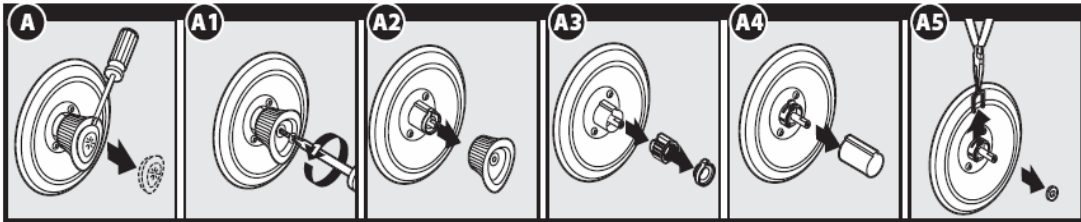

Step 3: Pull the cartridge from the valve body. If the cartridge is difficult to remove, the twisting tool supplied in cartridge repair kits (carded #98040 or bagged #96988) will permit the use of pliers to help break it loose

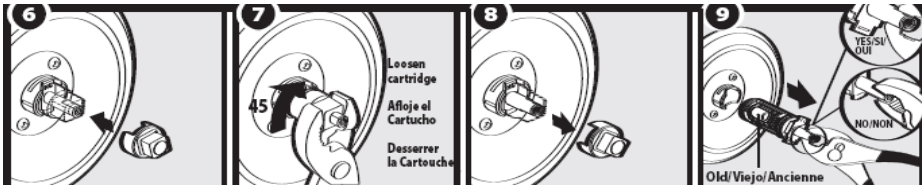

Step 4: Shake the cartridge once it is removed. It should sound similar to when you shake a spray paint can. If the cartridge rattles, reinstall it in the valve following the instructions in Step 9 and Step 10

If it does not rattle, hold the cartridge in your hand and depress the stem with your thumb. The stem will be pushed out the bottom of the outer shell

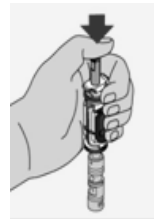

Step 5: Remove the white plastic plug (called the "end cap") and then pry the spool from the stem

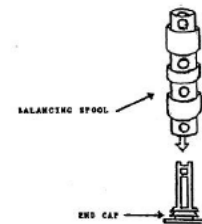

Step 6: Wipe the inside of the stem and the outside of the spool removing any foreign material (such as sediment)



Step 7: Reassemble the cartridge and shake it to hear if there is a "rattling" sound

Step 8: Before reinstalling the cartridge back into the valve body, turn on both the hot/cold water supplies lines very gradually in order to flush out both sides of the valve. Be prepared for a substantial amount of water that might splatter out of the tub/shower area (afterwards turn the supply lines back off)

Step 9: Reinstall the cartridge into the valve, insert the retainer clip and reassemble the trim and handle/knob. The cartridge retainer clip must be installed before turning the water back on

Step 10: Test the cartridge by fully turning on both the hot and cold supply lines and operating the faucet